



PCXSMT1603



SkyAir









AIR CONDITIONING SYSTEM
COOLING ONLY [50Hz]



R-410A

Product Lineup







Capacity	kW	25	35	50
Ceiling Cassette Type (2x2)				
	Indoor unit			
	Outdoor unit	RN25CXV1	RN35CXV1	RN50CXV1
Outdoor Unit				
		RN25CXV1	RN35CXV1	RN50CXV1

Capacity	kW	25	35	50	60	
Ceiling Cassette Type (3x3)						
	Indoor unit					
	Outdoor unit			RN50CAXV1	RN60CAXV1	
Duct Connection Low Static Pressure Type						
	Indoor unit					FDBRN25DXV1
	Outdoor unit	RN25FDXV1	RN35FAXV1	RN50CAXV1	RN60CAXV1	
Duct Connection Standard Static Pressure Type						
	Indoor unit					FDMRN25DXV1
	Outdoor unit	RN25FDXV1	RN35FAXV1	RN50CAXV1	RN60CAXV1	
Ceiling Suspended Type						
	Indoor unit					
	Outdoor unit			RN35FAXV1	RN50CAXV1	RN60CAXV1
Floor Standing Type						
	Indoor unit					
	Outdoor unit					
Outdoor Unit						
		RN25FDXV1	RN35FAXV1	RN50CAXV1	RN60CAXV1	

The solution for light commercial sector

Providing the ideal solution for all kinds of small commercial space such as shops, restaurant and small offices. The Sky Air series offers a complete comfort solution that puts you in total control.



71	100	125	140	160
				
FCRN71FXV1 RR71CAXV1	FCRN100FXV1 RR100DAXV1 / RR100DAXY1	FCRN125FXV1 RR125DAXY1	FCRN140FXV1 RR140DAXY1	
				
FDMRN71DXV1 RR71CAXV1	FDMRN125DXV1 RR100DAXV1	FDMRN125DXV1 RR125DAXY1	FDMRN140DXV1 RR140DAXY1	FDMRN160DXV1 RR160DAXY1
 				
FHRN71DXV1 RR71CAXV1	FHRN100DXV1 RR100DAXV1	FHRN125DXV1 RR125DAXY1	FHRN140DXV1 RR140DAXY1	FHRN160DXV1 RR160DAXY1
				
FVRN71BXV1 RR71CAXV1	FVRN100BXV1 RR100DAXV1	FVRN125BXV1 RR125DAXY1	FVRN140BXV1 RR140DAXY1	FVRN160BXV1 RR160DAXY1
 				
RR71CAXV1	RR100DAXV1 / RR100DAXY1	RR125DAXY1	RR140DAXY1	RR160DAXY1

Ceiling Cassette Type

4-way air flow ceiling cassette

2x2: FFRN25/35/50CXV1



3x3: FCRN50/60/71/100/125/140FXV1



Wired controller:
BRC51A62

* optional



Wireless controller:
BRC52A62

* supplied with panel



COMFORT							CLEANLINESS	WORK & SERVICING			CONTROL FEATURES		OPTIONS	OTHERS	
Auto swing	Swing pattern	Switchable fan speed	Programme "Dry"	Two selectable temperature sensor	Timer selector	Weekly scheduled timer	Washable saranet filter	Drain pump mechanism	Pre-charged for up to 7.5m	Self diagnosis	Auto random restart	Group control by Network Interface Module (NIM)	External command control using BAG	Fresh-air intake kit	Anti corrosion treated heat exchangers
●	●	●	●	*1	●	*1	●	●	●	●	●	●	●	●	*2

*1 Applicable when wired controller is used.

*2 The condenser comes with bare/blue fin. Gold fin condenser are optional.

4-way air flow

This unit promotes even air distribution covering every corner of the room by combining 4-ways air discharge and large discharge area.

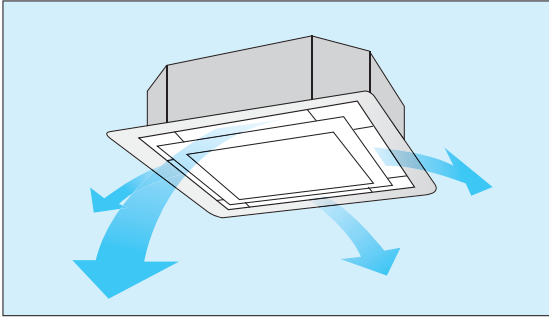

Compact body and quiet operation

Indoor units as an aerodynamically designed Diffuser Turbo Fan.



Fine square panels

Panel size is same for all models. It is easy to maintain a neat appearance when multiple units are installed.

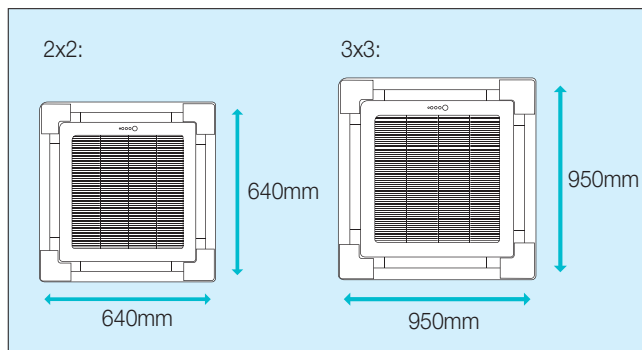

Draft resistance has been reduced by incorporating into a single unit, an impeller and a diffuser to control air flow inside the unit. The Diffuser Turbo Fan is both quiet during operation and compact.

Indoor Unit	Low dB(A)	Quiet* dB(A)
FCRN50F	33	29
FCRN60F	34	31
FCRN71F	35	32
FCRN100F	37	34
FCRN125F	41	37
FCRN140F	41	37

* Quiet mode is only available for FCRN series.

Optimal comfort and convenience assured by air discharge modes (FCRN series only)

To increase the comfort level of the air conditioned area, the system is built-in with 3 different types of air flow pattern to suit different requirements.

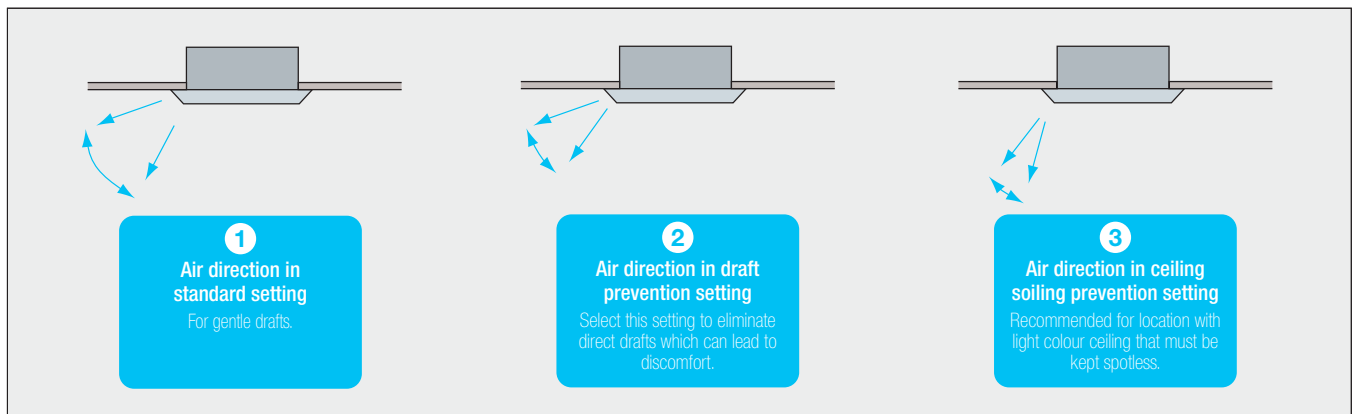

The default setting for air swing pattern is 1. The air swing pattern can be selected through the wireless remote control.

Two selectable temperature sensors

Both indoor unit and wired remote controller (option) contain temperature-sensors. Temperature sensing can be set at the unit or, to further improve comfort level, closer to the target area at the wired remote control. This feature must be set during commissioning by the technicians.

* Temperature-sensor on indoor unit must be used when the air conditioner is controlled from another room.

** Wireless remote controller does not have a temperature-sensor.

Switchable fan speed

High/Medium/Low/Quiet*

High setting provides maximum reach while low setting minimises drafts.

* Quiet mode is available for FCRN series only.

Timer selector

Operation starts when the preset time of the 'on' timer elapses and stops when the preset time of the 'off' timer elapses.

Powerful operation

New powerful operation boosts airflow to maximum volume for a 20-minute period **with highest fan speed**. After this, the unit automatically returns to its previous settings.

Easy installation (FCRN series only)

Quick and easy to install

Just 246mm high. Installable in tight ceiling spaces.

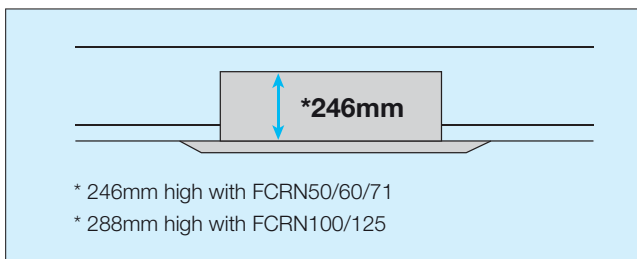

All models can be installed without using lifter because of the light weight.

Detachable corner

For the ease and flexibility of installation, this unit is designed with 4 detachable corners where installer is able to fit their hand in to adjust hanging hook and perform drain leakage check.

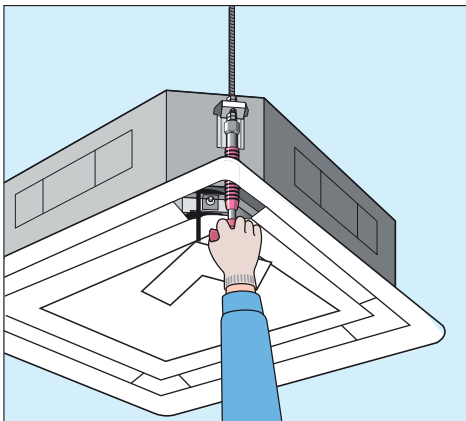

Indoor unit on/off switch

The unit can be conveniently started manually in the event the wireless remote controller is misplaced or the wireless remote controller batteries are not charged.

Extra protection

This unit covered with insulation material acts as extra protection when installed under very high humidity environment to prevent condensation.

Panel-hook mechanism

This feature enables the installer to work with both hands as the panel can be hung on the unit.

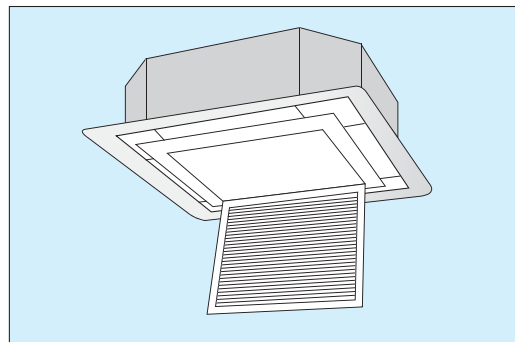

Position of connecting pipe and drain hose

In order to create more space for installer to work on connection pipe of indoor unit, the connection pipe of gas and liquid are located further from each other and purposely not align to hanging hook.

To enhance the convenience of installation, drain hose location is relocated to another side of cassette unit (not same side with connection pipe).

Easy accessible control box

Control box of this unit can be accessed directly from the intake grille for ease of installation and servicing process.

Drain pump is equipped as standard accessory with 700mm lift

This unit comes with a condensate water drain pump which can pump water up to 700mm higher from drain pipe outlet. Safety float is incorporated to monitor water level.

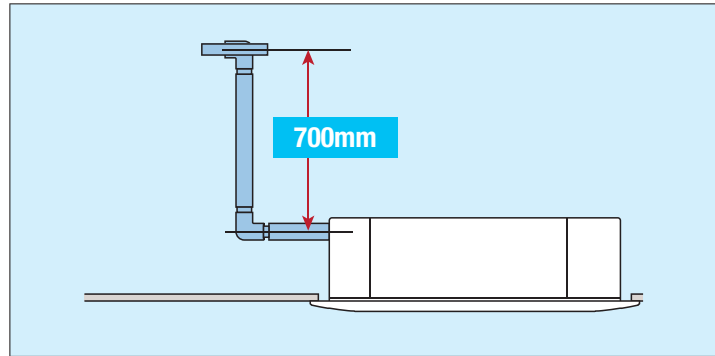

Easy maintenance

Easier to maintain

The condition of the drain pan and drain water can be checked by removing the drain plug and intake grille.

Simple step to change fan motor

- Without removing panel, it can be easily accessed and service to fan motor
- Reduced troubleshooting and servicing time
- Simple steps:
control box ► fan cover ► blower fan ► fan motor

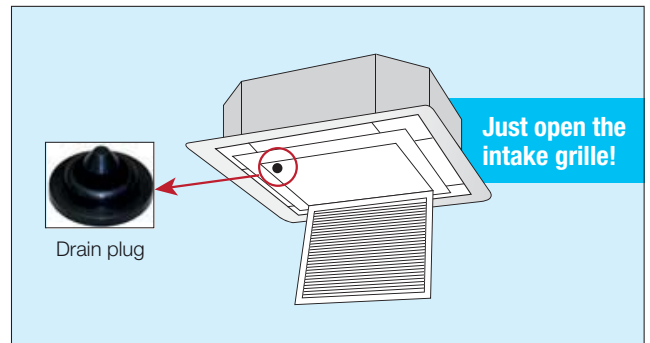

Self-diagnosis function

This intelligent feature helps to detect faults or malfunctioning in the system and give user a warning by blinking of the LED light or display error code on wired controller.

Options required for specific operating environments

Fresh air intake kit

Using this kit*, a duct can be fitted to increase the intake of outdoor air.

Knock-out hole

The built-in knock-out hole are available for fresh air intake or branch duct.

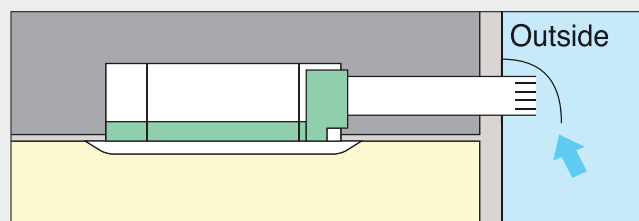

Note: *Connecting ducts, insect nets, fire dampers, air filters, and other parts should, as required, be procured locally.

Duct Connection Low Static & Standard Static Pressure Type

Flexible use of space is made possible using ducts to create a room filled with comfort

FDBRN25/35/50/60DXV1 (low static)



FDMRN25/35/50/60/71/125/140/160DXV1 (standard static)



Wired controller:
BRC51A62

* supplied with unit



Wireless controller:
BRC52A62

* optional



COMFORT					CLEANLINESS	WORK & SERVICING	CONTROL FEATURES			OTHERS	
Switchable fan speed	Programme "Dry"	Two selectable temperature sensor	Timer selector	Weekly scheduled timer	Washable saranet filter	Pre-charged for up to 7.5m	Self diagnosis	Auto random restart	Group control by Network Interface Module (NIM)	External command control using BAG	Anti corrosion treated heat exchangers
●	●	*1	●	*1	●	●	●	●	●	●	*2

*1 Applicable when wired controller is used.

*2 The condenser comes with bare/blue fin. Gold fin condenser are optional.

Thin, lightweight indoor unit makes delivery and installation easy

With a height of only 261 mm, installation is possible even in buildings with narrow ceiling spaces.

(mm)



Indoor Unit	25	35	50	60
Height	261			
Width	765	905	1065	1200
Depth	411			

Flexibility in system design

The unit offers fan motor that can operate up to 3 speeds, thus providing choices of external static pressure for designing ducting system.

Double protection drainage system

The primary drain pan is designed with high thermal insulation material and moulded in gradient for better condensate water drainage. The extra secondary drain pan "built in" to the standard unit offers extra protection against possible water leaking problems.

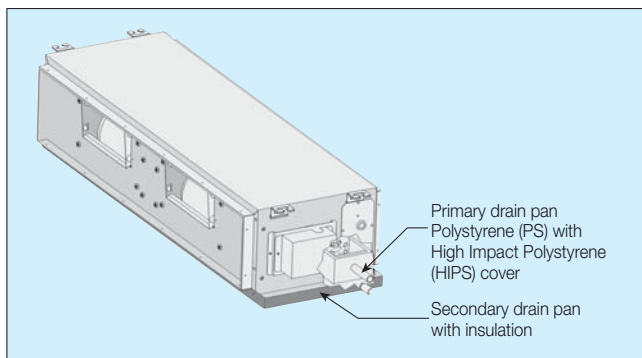

Two selectable temperature sensors

Both indoor unit and wired remote controller (option) contain temperature-sensors. Temperature sensing can be set at the unit or, to further improve comfort level, closer to the target area at the wired remote control. This feature must be set during commissioning by the technicians.

* Temperature-sensor on indoor unit must be used when the air conditioner is controlled from another room.

** Wireless remote controller does not have a temperature-sensor.

Switchable fan speed

High/Medium/Low

High setting provides maximum reach while low setting minimises drafts.

Simultaneous air conditioning of two rooms and ventilation grille (ventilation opening)

When air conditioning two rooms simultaneously, the air discharged into each room must be circulated back to the air conditioner. To achieve this, a ventilation duct should be installed for each room or one of the indicated ventilation grilles should be installed on the partitioning wall or under the door between the rooms.

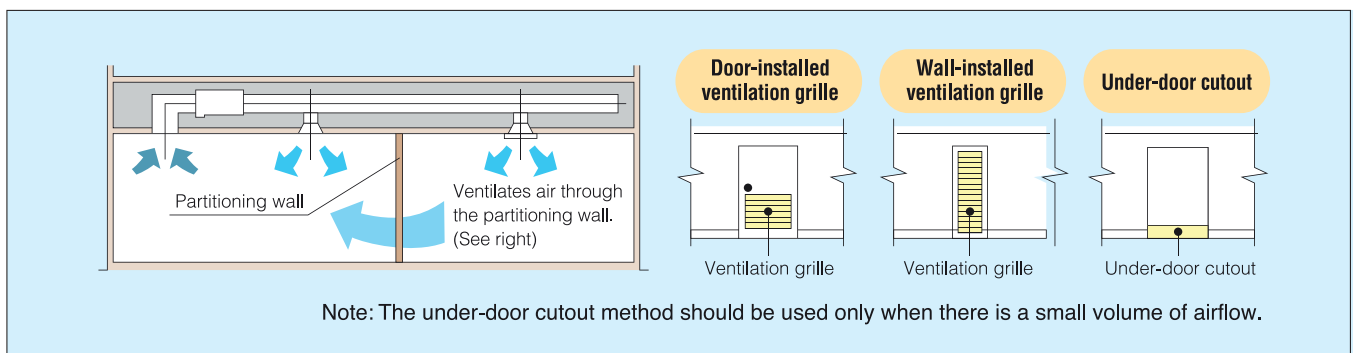

Ceiling Suspended Type

Uniformity with style, space saving

FHRN35/50/60DXV1



FHRN71DXV1



FHRN100/125/140/160DXV1



Wired controller:
BRC51A62

* optional



Wireless controller:
BRC52A62

* supplied with unit



COMFORT					CLEANLINESS	WORK & SERVICING		CONTROL FEATURES		OTHERS	
Switchable fan speed	Programme "Dry"	Two selectable temperature sensor	Timer selector	Weekly scheduled timer	Washable saranet filter	Pre-charged for up to 7.5m	Self diagnosis	Auto random restart	Group control by Network Interface Module (NIM)	External command control using BAG	Anti corrosion treated heat exchangers
●	●	*1	●	*1	●	●	●	●	●	●	*2

*1 Applicable when wired controller is used.

*2 The condenser comes with bare/blue fin. Gold fin condenser are optional.

Far and high air flow

Far air flow distance with high air flow ensuring the spaces of the room to be cooled down rapidly to the set temperature.

Two selectable temperature sensors

Both indoor unit and wired remote controller (option) contain temperature-sensors. Temperature sensing can be set at the unit or, to further improve comfort level, closer to the target area at the wired remote control. This feature must be set during commissioning by the technicians.

* Temperature-sensor on indoor unit must be used when the air conditioner is controlled from another room.

** Wireless remote controller does not have a temperature-sensor.

Switchable fan speed

High/Medium/Low

High setting provides maximum reach while low setting minimises drafts.

Timer selector

Operation starts when the preset time of the 'on' timer elapses and stops when the preset time of the 'off' timer elapses.

Easy Installation

Installation flexibility for freedom of design

Uniform height and depth. Compact design for small-capacity models to meet tighter dimensional constraints.

(mm)

Indoor Unit	35	50	60	71	100	125	140
Height	235						
Width	1203		1553		1903		
Depth	680						

Easy Maintenance

Easy-clean surfaces

It is easy to wipe dirt off the surfaces of the unit.

Ease of maintenance

For all maintenance tasks, access is from bottom surface.

Floor Standing Type

Space saving with style and functionality

FVRN71/100/125/140/160BXV1



Wired controller:
BRC51A62

* optional

Wireless controller:
BRC52A62

* supplied with unit



Far air flow

The Daikin floor standing is able to achieve air flow distance as far as 25m (size 160) which is about the size of a basketball court.

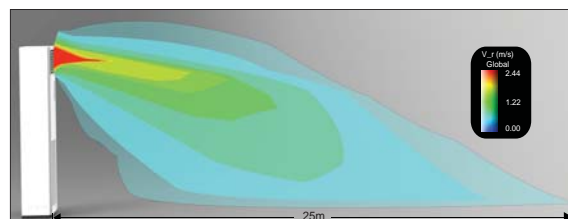

COMFORT						CLEANLINESS	WORK & SERVICING		CONTROL FEATURES		OTHERS	
Auto swing	Switchable fan speed	Programme "Dry"	Two selectable temperature sensor	Timer selector	Weekly scheduled timer	Washable saranet filter	Pre-charged for up to 7.5m	Self diagnosis	Auto random restart	Group control by Network Interface Module (NIM)	External command control using BAG	Anti corrosion treated heat exchangers
●	●	●	*1	●	*1	●	●	●	●	●	●	*2

*1 Applicable when wired controller is used.

*2 The condenser comes with bare/blue fin. Gold fin condenser are optional.

Auto-swing mode

This unit uses its automatic horizontal swing louver to spread comfortable air flow to cool every corner of the room. Its vertical louvers are adjusted manually to match different interior spaces and partition as well as to avoid direct airflow.

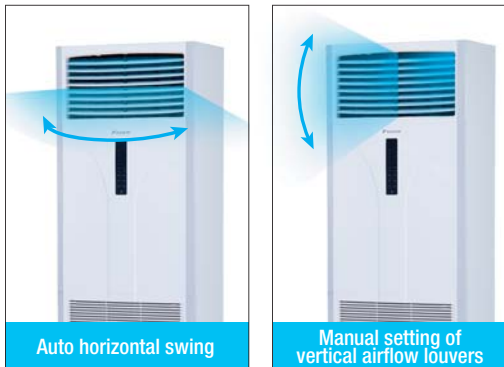

User-friendly controls

The unit comes with a stylish black control panel with white LED light for clear display. It comes with a keylock function to prevent setting change from unauthorised personnel.

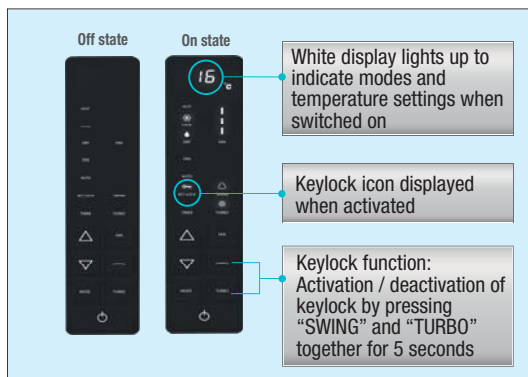

Additionally, this unit is incorporated with infrared sensor for usage with wireless controller which is supplied with the unit. Thus, it can be controlled using wireless controller for greater flexibility.



Two selectable temperature sensors

Both indoor unit and wired remote controller (option) contain temperature-sensors. Temperature sensing can be set at the unit or, to further improve comfort level, closer to the target area at the wired remote control. This feature must be set during commissioning by the technicians.

* Temperature-sensor on indoor unit must be used when the air conditioner is controlled from another room.

** Wireless remote controller does not have a temperature-sensor

Switchable fan speed

High/Medium/Low

High setting provides maximum reach while low setting minimizes drafts.

Timer selector

Operation starts when the preset time of the 'on' timer elapses and stops when the preset time of the 'off' timer elapses.

Powerful operation

New powerful operation boosts airflow to maximum volume for a 20-minute period **with highest fan speed**. After this, the unit automatically returns to its previous settings.

Indoor unit on/off switch

The unit can be conveniently started manually in the event the wireless remote controller is misplaced or the wireless remote controller batteries are not charged.

Easy maintenance

Safety clip

The safety clip feature allows users to remove the washable saranet filter with ease during maintenance. At the same time, it also acts as a safety feature to prevent the users from reaching into the electrical and mechanical components.



Space for water drain pump

There is a space in the unit below the fan that allows users to install an external condensate water pump.

* The condensate water drain pump is separately purchased and field installed.



Outdoor unit

Compact units, quiet operation



RN25/35CXV1



RN50CXV1



RN25FDXV1, RN35FAXV1



RN50/60CAXV1



RR71CAXV1



RR100DAXV1, RR100DAXY1
RR125/140/160DAXY1

Fitted with wide inlet fan

Fully shaped aerodynamic propellers are designed to push air with a large wing surface, providing both high blow volume and quiet operation with turbulence.



Wide inlet fan

Equipped with scroll compressor for quiet operation

Smooth running, minimal vibration, low operating sound (for RR100DAXV1/Y1 and RR125-160DAXY1).

Model	Sound pressure level, dB(A)
RR100D	58
RR125D	60
RR140D	63
RR160D	65



Pre-charged for up to 7.5 metres

Model	Max. piping length, m	Max. piping elevation, m
RN25C	12	5
RN35C		
RN25F	20	10
RN35F		
RN50C	12* / 30	8* / 15
RN60C	30	15

Model	Max. piping length, m	Max. piping elevation, m
RR71C	45	25
RR100D	50	30
RR125D		
RR140D		
RR160D	35 / 45**	15 / 25**

* Only applicable for FFRN50CXV1.

** Only applicable for FVRN160BXV1.

Durability

- The unit is covered with corrosion-proof galvanized steel to enhance its durability.
- Heat exchange fins are provided with anti-corrosion treatment.

Controller

Wireless controller BRC52A62

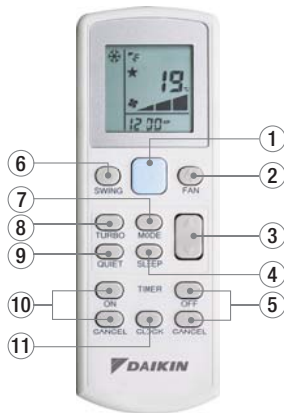

- ① "Glow-in-the-dark" on/off switch
- ② Fan speed selection: Low, Medium, High, Auto
- ③ Temperature setting: Up & down
- ④ Sleep mode function
- ⑤ Off timer setting
- ⑥ Vertical auto-swing
- ⑦ Selectable mode: Cool, Dry, Fan
- ⑧ Turbo function
- ⑨ Quiet function
- ⑩ On timer setting
- ⑪ Real time clock

Wired controller BRC51A62

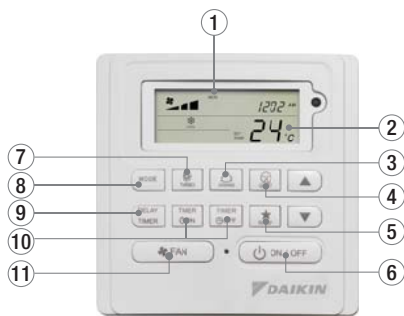

- ① Real time clock and day display
- ② Temperature operate in °C and °F
- ③ Swing function
- ④ Quiet function
- ⑤ Sleep function
- ⑥ On/off switch
- ⑦ Turbo function
- ⑧ Cool, Dry, Fan mode
- ⑨ Delay timer (1 or 2 hours)
- ⑩ 7-days programmable timer
- ⑪ Low, Medium, High, Auto fan speed

Wired controller BRC51A62 can directly be connected to the unit's main board to start operating without extra setting or modification. It also has a built-in temperature sensor that enables temperature sensing closer to target area for improved comfort (no settings required to activate the handset temperature sensor).

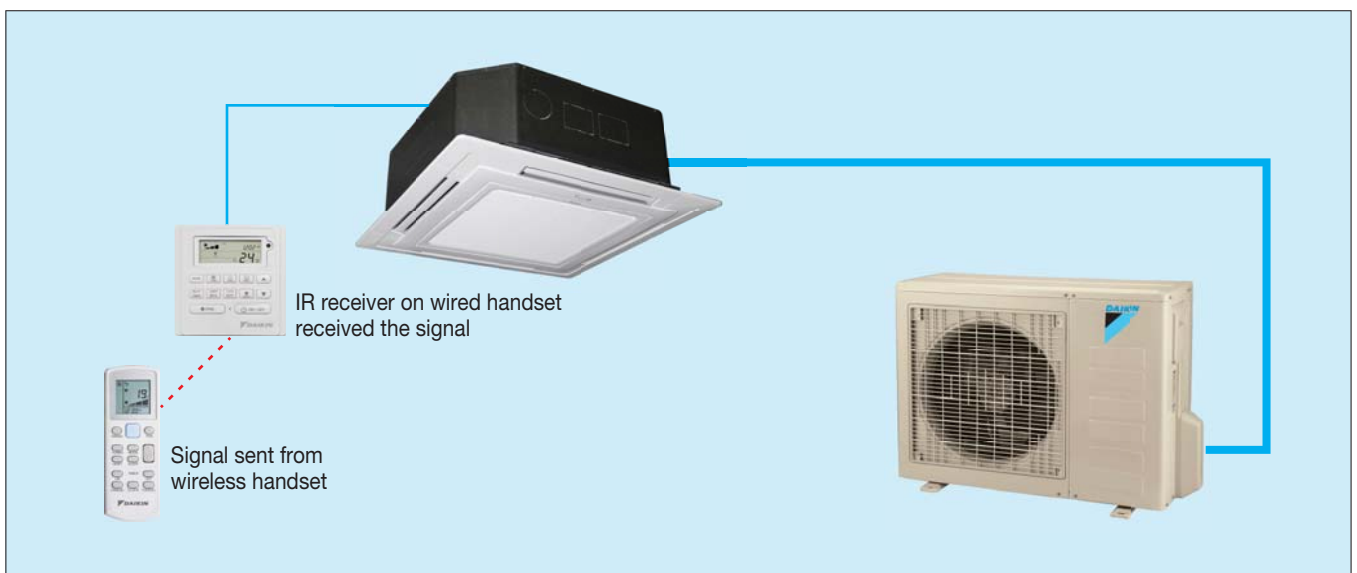

Simple system that provides flexibility of controls

	Control Pattern	Remote Controls
Group control by Network Interface module (NIM)	For simultaneous control of up to 16 indoor units	
Sequential control by Sequential Network Interface Module (S-NIM)	For sequential control of 2 indoor units at alternate sequence of pre-set hour	
Control by external command using BAG	Operation and surveillance is carried out using the contact signal from the operation control box in the building surveillance (security) room.	

Group control by Network Interface Module (NIM)

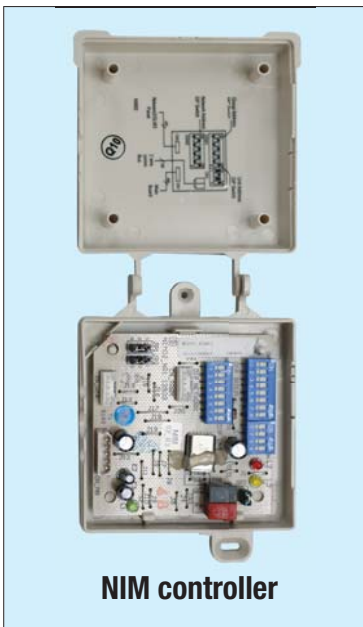

The NIM group controls consist of:

- Mainboard
- Control panel (BRC51A62)
- NIM controller
- Communication bus

NIM utilizes master-slave configurations. One master can control up to 15 slave units in a group. The master unit operates in conjunction with a control panel. Any settings done via the control panel connected to the master overwrite the settings of its slave units. Slave units can be operated with or without control panel. If a slave unit is operating with a control panel, its settings can be changed without following its master's.

- DIP switch setting for group and unit address
- Automatic detection of control panel
- Error codes and error unit's ID indication on control panel
- Supported configurations of NIM:

	Master	Slave
BRC51A62	•	•
BRC52A62		•

Sequential control by Sequential Network Interface Module (S-NIM)

Control two units of air conditioner in a master and slave system, operating at alternate sequence of preset hours (3/4/5/7/9/11/12 hours), controlled by a single BRC51A62 controller.

The S-NIM controls consist of:

- Mainboard
- Control panel (BRC51A62)
- S-NIM controller
- Communication bus

The S-NIM is suitable in environment requiring 24-hours air conditioning, such as server room, room containing critical electronics equipment, laboratories, telecommunication towers, railway switching centre and 24-hours shoplets. It also extends the operating lifetime of existing air conditioning units.

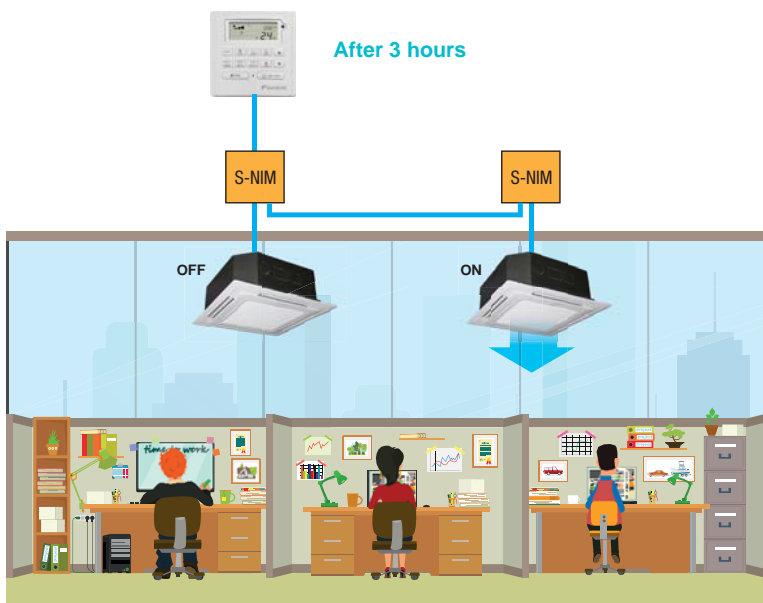
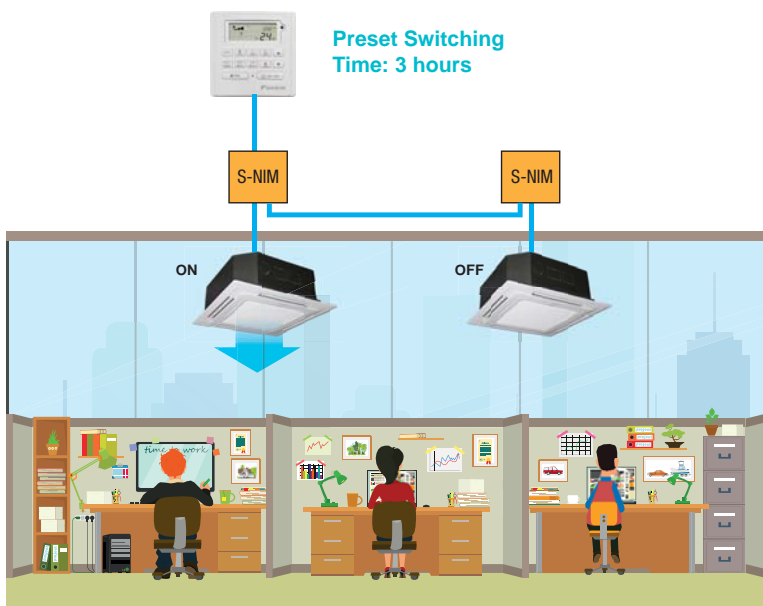

When the operating unit is faulty, the standby unit automatically takes over. Other features of S-NIM:

- Auto restart feature with last state settings.
- Error indication via error code display on the control panel.
- Pre-set operation hours via DIP switch.
- Maximum point to point distance of 1000m.

Network controls

Control by external command using BMS Access Gateway (BAG)



BAG interfaces the air conditioner unit to BMS system via input contacts, resistance inputs and dry contacts outputs which allows the monitoring and controls of the air conditioner. The BAG enables:

- Controls of the air conditioner unit's on/off status, operating mode, fan speed setting, room temperature setting as well as forcing off the unit in the event of fire.
- Indication to warn the control room in the event of air conditioner failure.
- Maximum point-to-point distance of 1100m (please refer to the installation manual)

Inputs	Input Controls	Applications
Input contacts	Force off/un-changed	Smoke alarm system
	On/off	Long distance unit on/off control
Resistance inputs	Temperature setting (16°C-30°C)	Long distance unit temperature setting control
Outputs	Output Indications	Applications
Relay outputs	On/off status	Long distance unit operation status monitoring
	Unit faulty/normal	

The BAG controls consist of:

- Mainboard
- Control panel (BRC51A62)
- BAG controller
- Communication bus

Individual air conditioners can be turned on from the control room's input contact connection:

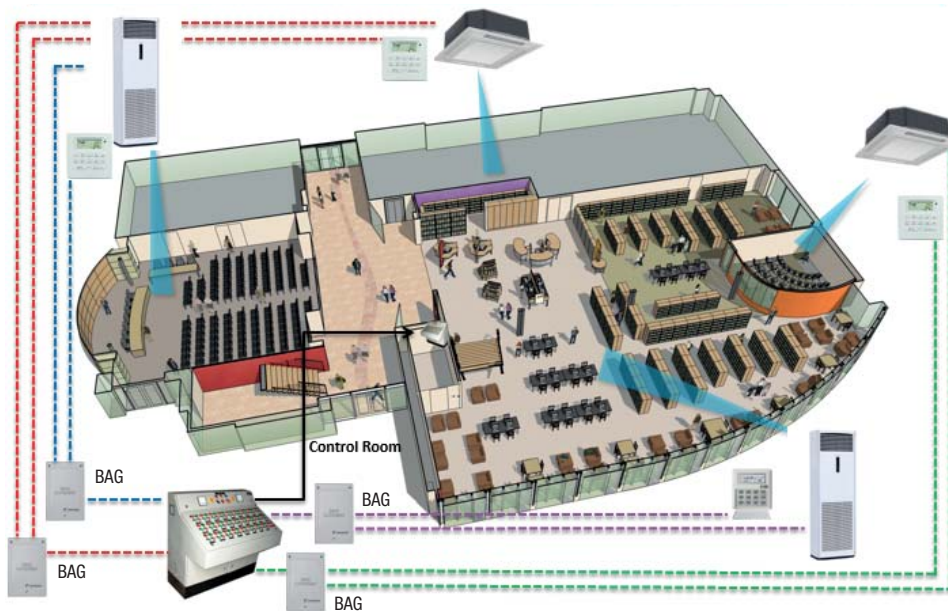

Note:

Communication bus:

A 2-way twisted pair cable is used as the communication bus. Recommended cable for communication bus is a pair of screened and shielded, twisted single core wire with core diameter of 0.5mm to 1.0mm.

Notes

Abundance of functions that provide comfortable air-conditioning in stores and offices

Comfort

Auto-swing

Delivers comfortable air-conditioning to all areas, near to and far from the air-conditioner.

Swing pattern selection

You can freely set 3 air discharge setting by remote controller.

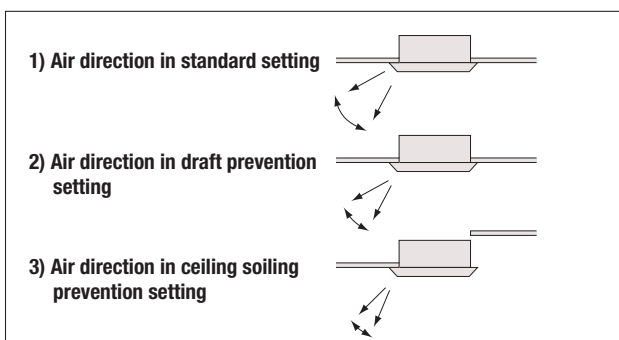

Switchable fan speed (available on all models)

Selectable High, Medium and Low fan speed. High setting provides maximum reach while low setting minimizes drafts.

Programme “Dry” (available on all models)

Dehumidification is microprocessor controlled to prevent abrupt and uncomfortable changes in air temperature. Useful for reducing uncomfortable humidity without uncomfortable cooling of the room.

Two selectable temperature-sensors

Temperature-sensors are included in the indoor unit and optional wired remote controller. temperature sensing closer to target area is possible to further increase the comfort level.

Use the temperature-sensor in the indoor unit when controlling air conditioning from another room.

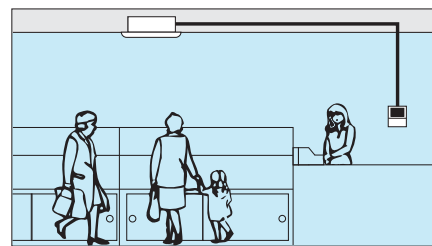

Note: Wireless remote controllers have no temperature-sensor

Timer selector

Operation starts when the preset time of the ‘on’ timer elapse and stops when the preset time of the ‘off’ timer elapses.

Weekly schedule timer

Available in Timer 1 and Timer 2 with operation on/off settings programmed for 7 days of the week.

Cleanliness

Washable saranet filter

Removal of air-borne dust particles through saranet filter ensures cleaner air supply.

Work and Servicing

Drain pump mechanism

Steeper gradient realises more efficient condensate drainage. High-lift is especially useful for long lengths of drain piping.

Pre-charge for up to 7.5 metres (available for all models)

If refrigerant piping length does not exceed 7.5m, there is no need for on-site gas charging. However for any piping length more than 7.5m, requires for additional charge.

Self diagnosis function (available on all models)

The operating parameters of indoor and outdoor units, and sensor data at critical locations throughout the system, are constantly monitored using a microcomputer. This intelligent feature helps to detect faults or malfunctioning in the system and give user a warning by blinking of the LED light on the unit or display error code on the wired controller.

Control features

Auto random restart (available on all models)

If there is a power outage while the equipment is operating, operations will restart randomly (within 180 to 244 seconds) in the same mode as before the power cut when electricity is restored.

Group control by Network Interface Module (NIM)

You can turn up to 16 indoor units on/off with a single remote controller. (When using connected indoor units, the settings must all be the same and on/off will be simultaneous.)

External command control using BMS Access Gateway (BAG)

Operation and surveillance is carried out using the contact signal from the operation control box in the building surveillance (security) room.

Options

Fresh-air intake kit

You can provide air-conditioning with fresh air from outside.
It is convenient for places where a ventilation fan cannot be installed.

Note: Connecting ducts, insect nets, fire dampers, air filters, and other parts should, as required, be procured locally.

Specification

Ceiling cassette 3x3

				50	60	71
Model	Indoor unit			FCRN50FXV1	FCRN60FXV1	FCRN71FXV1
	Outdoor unit			RN50CAXV1	RN60CAXV1	RR71CAXV1
	Decoration panel			BC50F2XW		
Nominal cooling capacity		Btu/h		18,500	23,000	28,000
			W	5,420	6,740	8,210
Nominal total input power		W	1,760	2,050	2,930	
Nominal running current		A	7.75	9.09	13.60	
EER		W/W	3.08	3.29	2.80	
Power supply		V/Ph/Hz	220-240/1/50 (power from indoor)			
Indoor unit	Airflow (H/M/L/Q)		cfm	730/620/510/360	840/700/560/440	890/760/620/490
	Sound pressure level (H/M/L/Q)		dB(A)	38/35/33/29	39/37/34/31	41/38/35/32
	Dimensions (HxWxD)	Unit	mm	246x840x840		
		With decoration panel	mm	301x950x950		
	Machine weight	Unit	kg	22		
Decoration panel		kg	5			
Outdoor unit	Sound pressure level		dB(A)	52	56	
	Dimensions (HxWxD)		mm	651x855x328	753x855x328	
	Machine weight		kg	43	47	57
Piping connections		Liquid (Flare)	mm	6.35	9.52	
		Gas (Flare)	mm	12.70	15.88	
Max. interunit piping length		m	30	45		
Max. installation level difference		m	15	25		

				100	125	140	
Model	Indoor unit			FCRN100FXV1	FCRN100FXV1	FCRN125FXV1	FCRN140FXV1
	Outdoor unit			RR100DAXV1	RR100DAXY1	RR125DAXY1	RR140DAXY1
	Decoration panel			BC50F2XW			
Nominal cooling capacity		Btu/h		36,000	36,000	42,000	45,000
			W	10,550	10,550	12,310	13,200
Nominal total input power		W	3,770	3,660	4,110	4,810	
Nominal running current		A	16.70	6.00	6.57	8.34	
EER		W/W	2.80	2.88	3.00	2.74	
Power supply		V/Ph/Hz	220-240/1/50 (power from outdoor)	380-415/3/50 (power from outdoor)			
Indoor unit	Airflow (H/M/L/Q)		cfm	1030/870/730/580		1120/1030/890/760	
	Sound pressure level (H/M/L/Q)		dB(A)	46/41/37/34		48/45/41/37	
	Dimensions (HxWxD)	Unit	mm	288x840x840			
		With decoration panel	mm	343x950x950			
	Machine weight	Unit	kg	25		29	
Decoration panel		kg	5				
Outdoor unit	Sound pressure level		dB(A)	58	60	63	
	Dimensions (HxWxD)		mm	852x1030x400			
	Machine weight		kg	71	95	98	
Piping connections		Liquid (Flare)	mm	9.52			
		Gas (Flare)	mm	15.88			
Max. interunit piping length		m	50				
Max. installation level difference		m	30				

Rated cooling capacities are based on the following conditions: Indoor temp. 27°CDB, 19°CWB; outdoor temp. 35°CDB; piping length: 7.5m

Specification

Ceiling cassette 2x2

				25	35	50
Model	Indoor unit			FFRN25CXV1	FFRN35CXV1	FFRN50CXV1
	Outdoor unit			RN25CXV1	RN35CXV1	RN50CXV1
	Decoration panel			BC20CXW		
Nominal cooling capacity		Btu/h		9,500	12,500	17,500
		W		2,780	3,660	5,130
Nominal total input power		W		900	1,300	1,690
Nominal running current		A		4.00	5.90	7.72
EER		W/W		3.09	2.82	3.03
Power supply		V/Ph/Hz		220-240/1/50 (power from indoor)		
Indoor unit	Airflow (H/M/L)		cfm	410/360/330		450/410/340
	Sound pressure level (H/M/L)		dB(A)	41/38/35	41/38/34	44/41/37
	Dimensions (HxWxD)	Unit	mm	250x570x570		
		With decoration panel	mm	295x640x640		
	Machine weight	Unit	kg	22	23	
Decoration panel		kg	2			
Outdoor unit	Sound pressure level		dB(A)	46	49	52
	Dimensions (HxWxD)		mm	540x700x250		651x855x328
	Machine weight		kg	28	30	47
Piping connections		Liquid (Flare)	mm	6.35		
		Gas (Flare)	mm	9.52	12.70	
Max. interunit piping length		m	12			
Max. installation level difference		m	5	8		

Duct connection low static pressure type

				25	35	50	60
Model	Indoor unit			FDBRN25DXV1	FDBRN35DXV1	FDBRN50DXV1	FDBRN60DXV1
	Outdoor unit			RN25FDXV1	RN35FAXV1	RN50CAXV1	RN60CAXV1
Nominal cooling capacity		Btu/h		9,000	12,000	17,400	20,800
		W		2,630	3,510	5,100	6,100
Nominal total input power		W		977	1,420	1,799	2,042
Nominal running current		A		4.38	6.35	7.93	9.03
EER		W/W		2.70	2.48	2.83	2.99
Power supply		V/Ph/Hz		220-240/1/50 (power from indoor)			
Indoor unit	Airflow (H/M/L)		cfm	250/220/180	410/370/280	540/520/480	607/580/530
	External static pressure (H/M/L)		Pa	10/8/5		20/19/16	20/18/15
	Sound pressure level (H/M/L)		dB(A)	32/29/26	36/33/27	38/37/35	40/39/38
	Dimensions (HxWxD)		mm	261x765x411	261x905x411	261x1065x411	261x1200x411
	Machine weight		kg	18	22	24	26
Outdoor unit	Sound pressure level		dB(A)	46	48	52	52
	Dimensions (HxWxD)		mm	550x658x273		651x855x328	
	Machine weight		kg	28	29	43	47
Piping connections		Liquid (Flare)	mm	6.35			
		Gas (Flare)	mm	9.52	12.70		15.88
Max. interunit piping length		m	20		30		
Max. installation level difference		m	10		15		

Rated cooling capacities are based on the following conditions: Indoor temp. 27°CDB, 19°CWB; outdoor temp. 35°CDB; piping length: 7.5m

Specification

Duct connection standard static pressure type

			25	35	50	60	71
Model	Indoor unit		FDMRN25DXV1	FDMRN35DXV1	FDMRN50DXV1	FDMRN60DXV1	FDMRN71DXV1
	Outdoor unit		RN25FDXV1	RN35FAXV1	RN50CAXV1	RN60CAXV1	RR71CAXV1
Nominal cooling capacity	Btu/h		9,000	12,000	17,400	20,800	30,000
	W		2,630	3,510	5,100	6,100	8,790
Nominal total input power	W		970	1,430	1,835	2,080	3,150
Nominal running current	A		4.35	6.41	8.12	9.24	14.40
EER	W/W		2.72	2.46	2.78	2.93	2.79
Power supply	V/Ph/Hz		220-240/1/50 (power from indoor)				
Indoor unit	Airflow (H/M/L)	cfm	250/225/200	410/360/330	540/520/470	607/581/512	970/880/750
	External static pressure (H/M/L)	Pa	30/25/18	30/23/19	40/37/30	50/46/35	100/82/60
	Sound pressure level (H/M/L)	dB(A)	33/30/26	37/34/29	39/38/37	41/40/39	47/45/42
	Dimensions (HxWxD)	mm	261x765x411	261x905x411	261x1065x411	261x1200x411	378x929x541
	Machine weight	kg	18	22	24	26	42
Outdoor unit	Sound pressure level	dB(A)	46	48	52	52	56
	Dimensions (HxWxD)	mm	550x658x273		651x855x328		753x855x328
	Machine weight	kg	28	29	43	47	57
Piping connections	Liquid (Flare)	mm	6.35				9.52
	Gas (Flare)	mm	9.52	12.70		15.88	
Max. interunit piping length	m	20		30		45	
Max. installation level difference	m	10		15		25	

			100	125	140	160
Model	Indoor unit		FDMRN125DXV1	FDMRN125DXV1	FDMRN140DXV1	FDMRN160DXV1
	Outdoor unit		RR100DAXV1	RR125DAXY1	RR140DAXY1	RR160DAXY1
Nominal cooling capacity	Btu/h		36,000	42,000	47,000	55,000
	W		10,550	12,310	13,770	16,120
Nominal total input power	W		4,150	4,500	5,100	5,758
Nominal running current	A		18.20	7.06	8.66	9.40
EER	W/W		2.54	2.74	2.70	2.80
Power supply	V/Ph/Hz		220-240/1/50 (power from outdoor)	380-415/3/50 (power from outdoor)		
Indoor unit	Airflow (H/M/L)	cfm	1300/1060/870		1500/1350/1250	1660/1400/1260
	External static pressure (H/M/L)	Pa	100/67/45		100/81/70	100/72/58
	Sound pressure level (H/M/L)	dB(A)	50/47/43		51/48/46	52/50/47
	Dimensions (HxWxD)	mm	378x1045x541		378x1299x541	378x1499x541
	Machine weight	kg	44		50	56
Outdoor unit	Sound pressure level	dB(A)	58	60	63	65
	Dimensions (HxWxD)	mm	852x1030x400			
	Machine weight	kg	71	95	98	105
Piping connections	Liquid (Flare)	mm	9.52			
	Gas (Flare)	mm	15.88		19.05	
Max. interunit piping length	m	50		35		
Max. installation level difference	m	30		15		

Rated cooling capacities are based on the following conditions: Indoor temp. 27°CDB, 19°CWB; outdoor temp. 35°CDB; piping length: 7.5m

Specification

Ceiling suspended

			35	50	60	71	
Model	Indoor unit		FHRN35DXV1	FHRN50DXV1	FHRN60DXV1	FHRN71DXV1	
	Outdoor unit		RN35FAXV1	RN50CAXV1	RN60CAXV1	RR71CAXV1	
Nominal cooling capacity			Btu/h	12,500	18,000	21,000	28,300
			W	3,660	5,270	6,150	8,290
Nominal total input power			W	1,270	1,760	2,020	2,950
Nominal running current			A	5.69	7.80	9.00	13.70
EER			W/W	2.88	3.00	3.05	2.81
Power supply			V/Ph/Hz	220-240/1/50 (power from indoor)			
Indoor unit	Airflow (H/M/L)		cfm	550/484/382	608/586/466		792/707/613
	Sound pressure level (H/M/L)		dB(A)	43/38/34	46/43/39		46/44/40
	Dimensions (HxWxD)		mm	235x1203x680			235x1553x680
	Machine weight		kg	30	31		41
Outdoor unit	Sound pressure level		dB(A)	48	52		56
	Dimensions (HxWxD)		mm	550x658x273	651x855x328		753x855x328
	Machine weight		kg	29	43	47	57
Piping connections			Liquid (Flare)	mm		6.35	9.52
			Gas (Flare)	mm	12.70		15.88
Max. interunit piping length			m	20	30		45
Max. installation level difference			m	10	15		25

			100	125	140	160	
Model	Indoor unit		FHRN100DXV1	FHRN125DXV1	FHRN140DXV1	FHRN160DXV1	
	Outdoor unit		RR100DAXV1	RR125DAXY1	RR140DAXY1	RR160DAXY1	
Nominal cooling capacity			Btu/h	34,400	42,000	44,500	55,000
			W	10,080	12,310	13,040	16,120
Nominal total input power			W	3,800	4,100	4,900	6,414
Nominal running current			A	16.90	6.67	8.52	9.60
EER			W/W	2.65	3.00	2.66	2.51
Power supply			V/Ph/Hz	220-240/1/50 (power from indoor)	380-415/3/50 (power from outdoor)		
Indoor unit	Airflow (H/M/L)		cfm	1015/930/749	1107/999/751	1247/1187/1113	1550/1320/1000
	Sound pressure level (H/M/L)		dB(A)	48/44/41	49/45/43	54/52/50	56/53/46
	Dimensions (HxWxD)		mm	235x1903x680			285x1903x680
	Machine weight		kg	51	52	55	70
Outdoor unit	Sound pressure level		dB(A)	58	60	63	65
	Dimensions (HxWxD)		mm	852x1030x400			
	Machine weight		kg	71	95	98	105
Piping connections			Liquid (Flare)	mm		9.52	
			Gas (Flare)	mm	15.88		19.05
Max. interunit piping length			m	50		35	
Max. installation level difference			m	30		15	

Rated cooling capacities are based on the following conditions: Indoor temp. 27°CDB, 19°CWB; outdoor temp. 35°CDB; piping length: 7.5m

Specification

Floor standing

			71	100	125	140	160	
Model	Indoor unit		FVRN71BXV1	FVRN125BXV1	FVRN125BXV1	FVRN140BXV1	FVRN160BXV1	
	Outdoor unit		RR71CAXV1	RR100DAXV1	RR125DAXY1	RR140DAXY1	RR160DAXY1	
Nominal cooling capacity		Btu/h	29,000	36,000	42,000	45,000	55,000	
		W	8,490	10,550	12,310	13,180	16,120	
Nominal total input power		W	2,900	3,860	4,100	4,900	5,490	
Nominal running current		A	13.40	17.10	6.58	8.42	9.35	
EER		W/W	2.93	2.73	3.00	2.69	2.94	
Power supply		V/Ph/Hz	220-240/1/50 (power from outdoor)	220-240/1/50 (power from indoor)	380-415/3/50 (power from outdoor)			
Indoor unit	Airflow (H/M/L)	cfm	675/625/530	1035/945/845	1035/945/845	1035/935/835	1170/1085/985	
	Sound pressure level (H/M/L)	dB(A)	44/42/39	49/47/44		50/48/46	54/53/51	
	Dimensions (HxWxD)	mm	1850x600x270	1850x600x350				
	Machine weight	kg	42	45		48	51	
Outdoor unit	Sound pressure level	dB(A)	56	58	60	63	65	
	Dimensions (HxWxD)	mm	753x855x328	852x1030x400				
	Machine weight	kg	57	71	95	98	105	
Piping connections		Liquid (Flare)	mm				9.52	
		Gas (Flare)	mm				15.88	
Max. interunit piping length		m	45	50			45	
Max. installation level difference		m	25	30			25	

Rated cooling capacities are based on the following conditions: Indoor temp. 27°CDB, 19°CWB; outdoor temp. 35°CDB; piping length: 7.5m

Notes

Warning



- Daikin products are manufactured for export to numerous countries throughout the world. Prior to purchase, please confirm with your local authorised importer, distributor and/or retailer whether this product conforms to the applicable standards, and is suitable for use, in the region where the product will be used. This statement does not purport to exclude, restrict or modify the application of any local legislation.
- Use only those parts and accessories supplied or specified by Daikin.
- Read the User's Manual carefully before using this product. The User's Manual provides important safety instructions and warnings. Be sure to follow these instructions and warnings.

If you have any enquiries, please contact your local importer, distributor and/or retailer.

Dealer

DAIKIN MALAYSIA SDN. BHD.

Lot 60334, Persiaran Bukit Rahman Putra 3,
Taman Perindustrian Bukit Rahman Putra,
47000 Sungai Buloh, Selangor Darul Ehsan, Malaysia
www.daikinmalaysia.com

DAIKIN INDUSTRIES, LTD.

Head office:
Umeda Center Bldg., 2-4-12, Nakazaki-Nishi,
Kita-ku, Osaka, 530-8323 Japan.